







Main Switch 20A-315A



Disconnect Switches

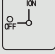

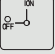
Enclosed switches with mild steel enclosure (powder coated – RAL 7035)
 Cover interlock in ON position
 3 up to 8 pole
 20 A up to 315 A
 IP66

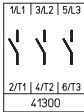
Switching programme	Rated data (IEC 60947)			Enclosure dimension (H × W × D) (mm)	Padlock device N-handle black	Padlock device M-handle black	Padlockable handle V-handle silver/black
	Operat. current I _e	Operational power (at 380–440 V)			 	 	 
		AC-21A (A)	AC-23A (kW)		AC-3 (kW)	IP66	IP66
				Order code number	Order code number	Order code number	
41300 – 3 pole – without auxiliary contacts	20	5.5	3.7	150 × 150 × 120	H216-41300-087N1	H216-41300-087M1	H216-41300-087V1
	20	5.5	3.7	200 × 150 × 120	H216-41300-187N1	H216-41300-187M1	H216-41300-187V1
	25	7.5	5.5	150 × 150 × 120	H220-41300-087N1	H220-41300-087M1	H220-41300-087V1
	25	7.5	5.5	200 × 150 × 120	H220-41300-187N1	H220-41300-187M1	H220-41300-187V1
	32	11	7.5	150 × 150 × 120	H226-41300-087N1	H226-41300-087M1	H226-41300-087V1
	32	11	7.5	200 × 150 × 120	H226-41300-187N1	H226-41300-187M1	H226-41300-187V1
	40	15	11	200 × 150 × 120	H233-41300-187N1	H233-41300-187M1	H233-41300-187V1
	40	15	11	200 × 150 × 120	B240-41300-087N1*	B240-41300-087M1*	B240-41300-087V1*
	50	18.5	15	200 × 150 × 120	B250-41300-087N1	B250-41300-087M1	B250-41300-087V1
	63	22	18.5	200 × 150 × 120	B263-41300-087N1	B263-41300-087M1	B263-41300-087V1
	63	22	18.5	200 × 150 × 120	H406-41300-987N1*	H406-41300-987M1*	–
	63	22	18.5	300 × 250 × 150	H406-41300-187N1	H406-41300-187M1	–
	63	22	18.5	400 × 300 × 155	H406-41300-182N1 ¹	H406-41300-182M1 ¹	–
	80	30	22	200 × 150 × 120	H408-41300-987N1	H408-41300-987M1	–
	80	30	22	300 × 250 × 150	H408-41300-187N1	H408-41300-187M1	–
	80	30	22	400 × 300 × 155	H408-41300-182N1 ¹	H408-41300-182M1 ¹	–
100	37	30	300 × 250 × 150	H410-41300-187N1	H410-41300-187M1	–	
100	37	30	400 × 300 × 155	H410-41300-182N1 ¹	H410-41300-182M1 ¹	–	
125	45	37	300 × 250 × 150	H412-41300-187N1	H412-41300-187M1	–	
125	45	37	400 × 300 × 155	H412-41300-182N1 ¹	H412-41300-182M1 ¹	–	





Rated data (IEC 60947)			Enclosure dimension (H × W × D) (mm)	Padlock device H-handle silver/black
Operat. current I _e	Operational power (at 380–440 V)			 
	AC-21A (A)	AC-23A (kW)		AC-3 (kW)
				Order code number
160	75	45	500 × 400 × 300	K616-41300-187H1 ¹
315	132	55	600 × 400 × 300	K830-41300-187H1 ¹
315	132	55	800 × 400 × 300	K830-41300-287H1 ¹

¹ hinged door



Main Switch 20A-315A

Disconnect Switches

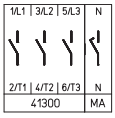
Switching programme	Rated data (IEC 60947)			Enclosure dimension (H x W x D) (mm)	Padlock device N-handle black	Padlock device M-handle black	Padlockable handle V-handle silver/black
	Operat. current I _n (A)	Operational power (at 380–440 V)					
		AC-21A (A)	AC-23A (kW)		AC-3 (kW)	IP66	IP66
				Order code number	Order code number	Order code number	
41400 – 4 pole – without auxiliary contacts – neutral contact early make/late break 	20	5.5	3.7	150 x 150 x 120	H216-41400-087N1	H216-41400-087M1	H216-41400-087V1
	20	5.5	3.7	200 x 150 x 120	H216-41400-187N1	H216-41400-187M1	H216-41400-187V1
	25	7.5	5.5	150 x 150 x 120	H220-41400-087N1	H220-41400-087M1	H220-41400-087V1
	25	7.5	5.5	200 x 150 x 120	H220-41400-187N1	H220-41400-187M1	H220-41400-187V1
	32	11	7.5	150 x 150 x 120	H226-41400-087N1	H226-41400-087M1	H226-41400-087V1
	32	11	7.5	200 x 150 x 120	H226-41400-187N1	H226-41400-187M1	H226-41400-187V1
	40	15	11	200 x 150 x 120	H233-41400-187N1	H233-41400-187M1	H233-41400-187V1
	40	15	11	200 x 150 x 120	B240-41400-087N1*	B240-41400-087M1*	B240-41400-087V1*
	50	18.5	15	200 x 150 x 120	B250-41400-087N1	B250-41400-087M1	B250-41400-087V1
	63	22	18.5	200 x 150 x 120	B263-41400-087N1	B263-41400-087M1	B263-41400-087V1
	63	22	18.5	200 x 150 x 120	H406-41400-987N1*	H406-41400-987M1*	–
	63	22	18.5	300 x 250 x 150	H406-41400-187N1	H406-41400-187M1	–
	63	22	18.5	400 x 300 x 155	H406-41400-182N1 ¹	H406-41400-182M1 ¹	–
	80	30	22	200 x 150 x 120	H408-41400-987N1	H408-41400-987M1	–
	80	30	22	300 x 250 x 150	H408-41400-187N1	H408-41400-187M1	–
	80	30	22	400 x 300 x 155	H408-41400-182N1 ¹	H408-41400-182M1 ¹	–
100	37	30	300 x 250 x 150	H410-41400-187N1	H410-41400-187M1	–	
100	37	30	400 x 300 x 155	H410-41400-182N1 ¹	H410-41400-182M1 ¹	–	
125	45	37	300 x 250 x 150	H412-41400-187N1	H412-41400-187M1	–	
125	45	37	400 x 300 x 155	H412-41400-182N1 ¹	H412-41400-182M1 ¹	–	

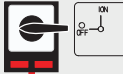

Rated data(IEC 60947)			Enclosure dimension (H x W x D) (mm)	Padlock device H-handle silver/black
Operat. current I _n (A)	Operational power (at 380–440 V)			
	AC-21A (A)	AC-23A (kW)		AC-3 (kW)
				Order code number
160	75	45	500 x 400 x 300	K616-41400-187H1 ¹
315	132	55	600 x 400 x 300	K830-41400-187H1 ¹
315	132	55	800 x 400 x 300	K830-41400-287H1 ¹

¹ hinged door



Main Switch 20A-315A

Disconnect Switches

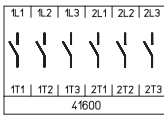
Switching programme	Rated data (IEC 60947)			Enclosure dimension (H × W × D) (mm)	Padlock device N-handle black	Padlock device M-handle black	Padlockable handle V-handle silver/black
	Operat. current I _n	Operational power (at 380–440 V)			 OFF-ON	 ON OFF	 ON OFF
	AC-21A (A)	AC-23A (kW)	AC-3 (kW)		IP66	IP66	IP66
					Order code number	Order code number	Order code number
41600 – 6 pole – without auxiliary contacts 	20	5.5	3.7	200 × 150 × 120	H216-41600-187N1	H216-41600-187M1	H216-41600-187V1
	25	7.5	5.5	200 × 150 × 120	H220-41600-187N1	H220-41600-187M1	H220-41600-187V1
	32	11	7.5	200 × 150 × 120	H226-41600-187N1	H226-41600-187M1	H226-41600-187V1
	40	15	11	200 × 150 × 120	H233-41600-187N1	H233-41600-187M1	H233-41600-187V1
	40	15	11	300 × 250 × 150	B240-41600-187N1	B240-41600-187M1	–
	50	18.5	15	300 × 250 × 150	B250-41600-187N1	B250-41600-187M1	–
	63	22	18.5	300 × 250 × 150	B263-41600-187N1	B263-41600-187M1	–
	63	22	18.5	300 × 250 × 150	H406-41600-187N1*	H406-41600-187M1*	–
	63	22	18.5	400 × 300 × 155	H406-41600-182N1 ¹	H406-41600-182M1 ¹	–
	80	30	22	300 × 250 × 150	H408-41600-187N1	H408-41600-187M1	–
	80	30	22	400 × 300 × 155	H408-41600-182N1 ¹	H408-41600-182M1 ¹	–
	100	37	30	300 × 250 × 150	H410-41600-187N1	H410-41600-187M1	–
	100	37	30	400 × 300 × 155	H410-41600-182N1 ¹	H410-41600-182M1 ¹	–
	125	45	37	300 × 250 × 150	H412-41600-187N1	H412-41600-187M1	–
125	45	37	400 × 300 × 155	H412-41600-182N1 ¹	H412-41600-182M1 ¹	–	



Rated data (IEC 60947)			Enclosure dimension (H × W × D) (mm)	Padlock device H-handle silver/black
Operat. current I _n	Operational power (at 380–440 V)			 ON OFF
AC-21A (A)	AC-23A (kW)	AC-3 (kW)		IP66
				Order code number
160	75	45	500 × 400 × 300	K616-41600-187H1 ¹
315	132	55	600 × 400 × 300	K830-41600-187H1 ¹
315	132	55	800 × 400 × 300	K830-41600-287H1 ¹

¹ hinged door



Main Switch 20A-315A

Disconnect Switches

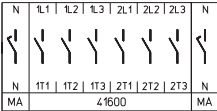
Switching programme	Rated data (IEC 60947)			Enclosure dimension (H × W × D) (mm)	Padlock device N-handle black	Padlock device M-handle black	Padlockable handle V-handle silver/black
	Operat. current I _b (A)	Operational power (at 380–440 V) (kW)			 OFF-ON	 OFF-ON	 OFF-ON
		AC-21A	AC-23A		AC-3	IP66	IP66
41800 – 8 pole – without auxiliary contacts – 2 neutral contacts early make/late break 	20	5.5	3.7	200 × 150 × 120	H216-41800-187N1	H216-41800-187M1	H216-41800-187V1
	25	7.5	5.5	200 × 150 × 120	H220-41800-187N1	H220-41800-187M1	H220-41800-187V1
	32	11	7.5	200 × 150 × 120	H226-41800-187N1	H226-41800-187M1	H226-41800-187V1
	40	15	11	200 × 150 × 120	H233-41800-187N1	H233-41800-187M1	H233-41800-187V1
	40	15	11	300 × 250 × 150	B240-41800-187N1	B240-41800-187M1	–
	50	18.5	15	300 × 250 × 150	B250-41800-187N1	B250-41800-187M1	–
	63	22	18.5	300 × 250 × 150	B263-41800-187N1	B263-41800-187M1	–
	63	22	18.5	300 × 250 × 150	H406-41800-187N1 ¹	H406-41800-187M1 ¹	–
	63	22	18.5	400 × 300 × 155	H406-41800-182N1 ¹	H406-41800-182M1 ¹	–
	80	30	22	300 × 250 × 150	H408-41800-187N1	H408-41800-187M1	–
	80	30	22	400 × 300 × 155	H408-41800-182N1 ¹	H408-41800-182M1 ¹	–
	100	37	30	300 × 250 × 150	H410-41800-187N1	H410-41800-187M1	–
	100	37	30	400 × 300 × 155	H410-41800-182N1 ¹	H410-41800-182M1 ¹	–
	125	45	37	300 × 250 × 150	H412-41800-187N1	H412-41800-187M1	–
125	45	37	400 × 300 × 155	H412-41800-182N1 ¹	H412-41800-182M1 ¹	–	

Rated data (IEC 60947)			Enclosure dimension (H × W × D) (mm)	Padlock device H-handle silver/black
Operat. current I _b (A)	Operational power (at 380–440 V) (kW)			 OFF-ON
	AC-21A	AC-23A		AC-3
160	75	45	500 × 400 × 300	K616-41800-187H1 ¹
315	132	55	600 × 400 × 300	K830-41800-187H1 ¹
315	132	55	800 × 400 × 300	K830-41800-287H1 ¹

¹ hinged door



Main Switch 20A-315A

Disconnect Switches

Dimensions (mm)

Setup of order code number

Type H216	Switching progr. 41400	Mtg. form 087M1
Order code no. H216-41400-087M1		

Mild steel enclosure 150 × 150 × 120 mm / 200 × 150 × 120 mm / 300 × 250 × 150 mm

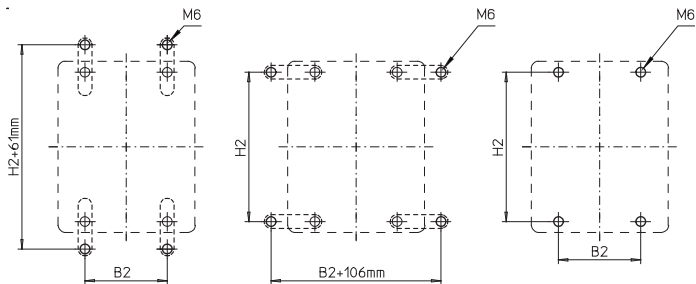
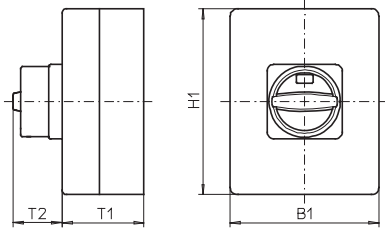

Types H216 / H220 / H226 / H233:

Mtg. form	H1	B1	T1	T2	H2	B2
087M1	150	150	120	38	132	85
087N1	150	150	120	33	132	85
087V1	150	150	120	39	132	85
187M1	200	150	120	38	182	85
187N1	200	150	120	33	182	85
187V1	200	150	120	39	182	85

Types B240 / B250 / B263:

Mtg. form	H1	B1	T1	T2	H2	B2
087M1	200	150	120	38	182	85
087N1	200	150	120	33	182	85
087V1	200	150	120	39	182	85
187M1	300	250	150	50	282	185
187N1	300	250	150	45	282	185

Types H406 / H408 / H410 / H412:

Mtg. form	H1	B1	T1	T2	H2	B2
187M1	300	250	150	50	282	185
187N1	300	250	150	45	282	185
987M1	200	150	120	50	182	85
987N1	200	150	120	45	182	85

Mild steel enclosure 400 × 300 × 155 mm

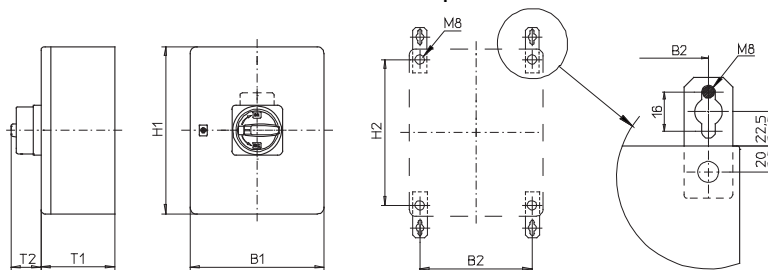

Types H406 / H408 / H410 / H412:

Mtg. form	H1	B1	T1	T2	H2	B2
182M1	400	300	155	50	360	260
182N1	400	300	155	45	360	260

Gland plate at the bottom



Main Switch 20A-315A

Disconnect Switches

Dimensions (mm)

Setup of order code number		
Type K616	Switching progr. 41300	Mtg. form 187H1
Order code no. K616-41300-087H1		

Mild steel enclosure 500 × 400 × 300 mm / 600 × 400 × 300 mm / 800 × 400 × 300 mm

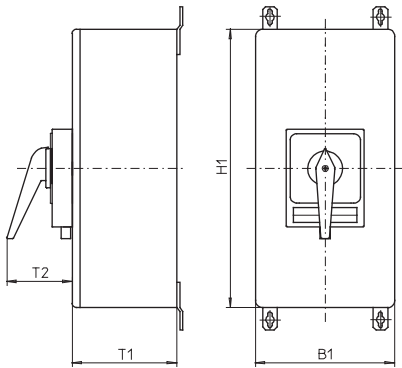

Type K616:

Mtg. form	H1	B1	T1	T2	H2	B2
187H1	500	400	300	83	545	360

Type K830:

Mtg. form	H1	B1	T1	T2	H2	B2
187H1	600	400	300	93	645	360
287H1	800	400	300	93	845	360

Further switching programmes and corresponding dimensions for types K on request.
Gland plate at the bottom

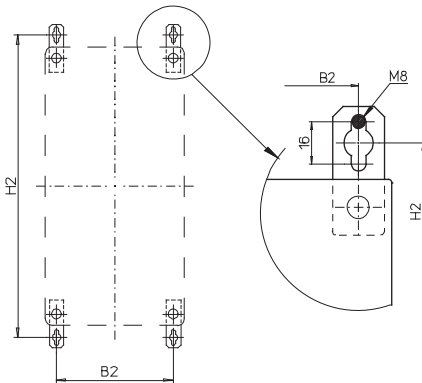

Mounting brackets are included.